

# Instructions for Cardboard Castle

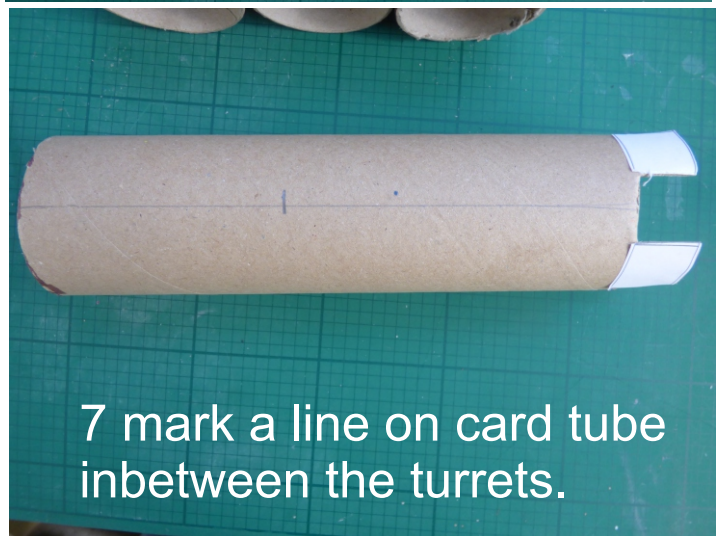

# Instructions for Cardboard Castle

8. Make a 7.5 cm line on the turret

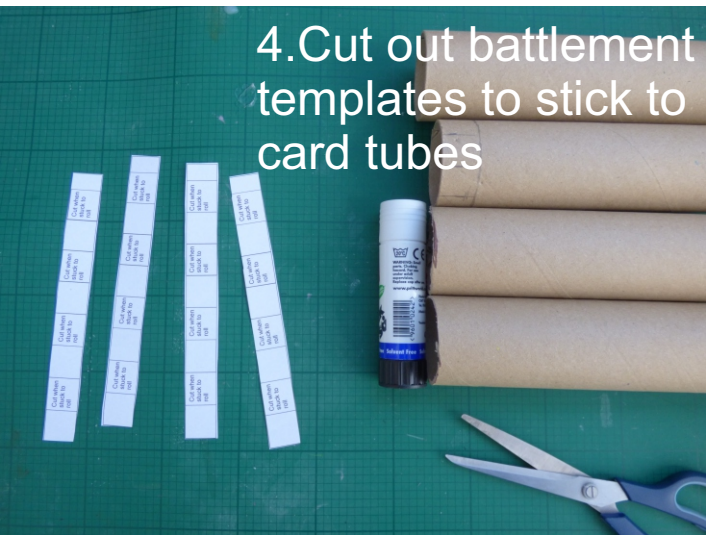
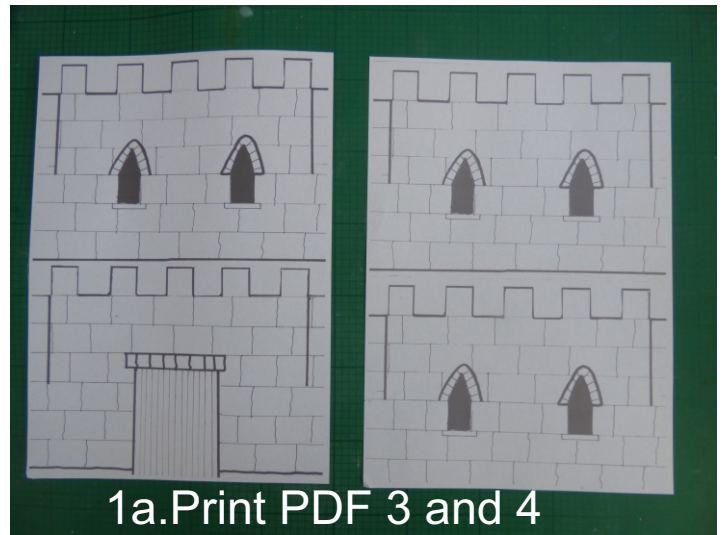
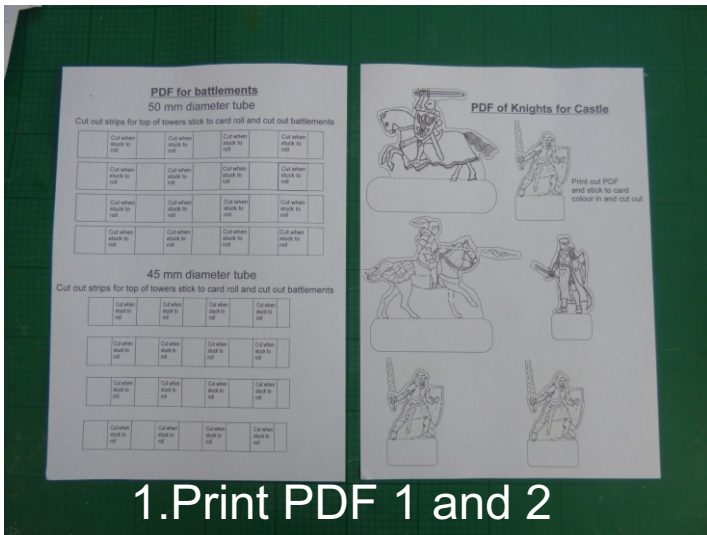
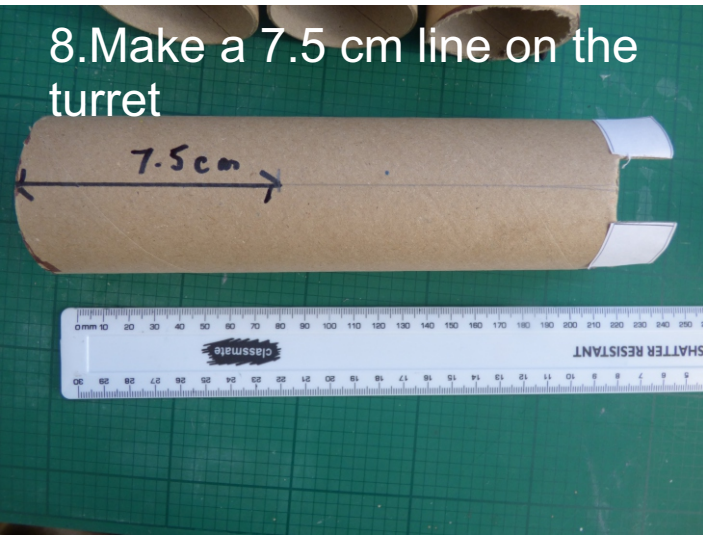

9. Cut a 7.5 cm slot in each turret



10. 4 turrets with slots and battlements cut



11; Top view of 4 turrets

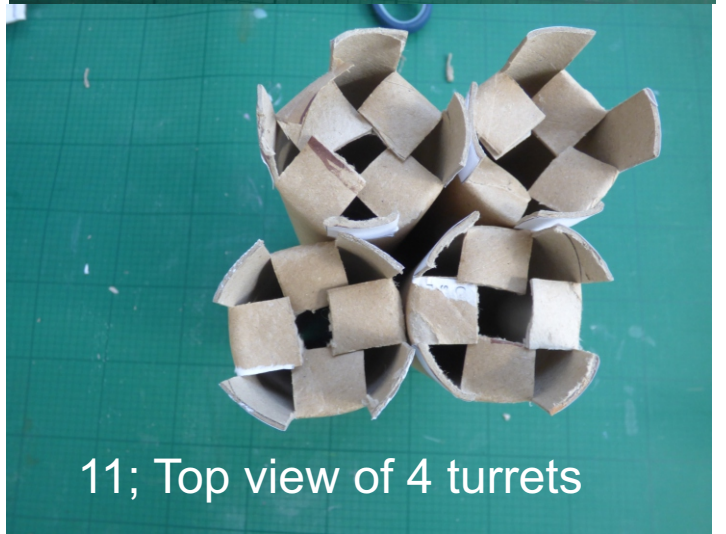

12. Stick the 4 side pdfs to the card

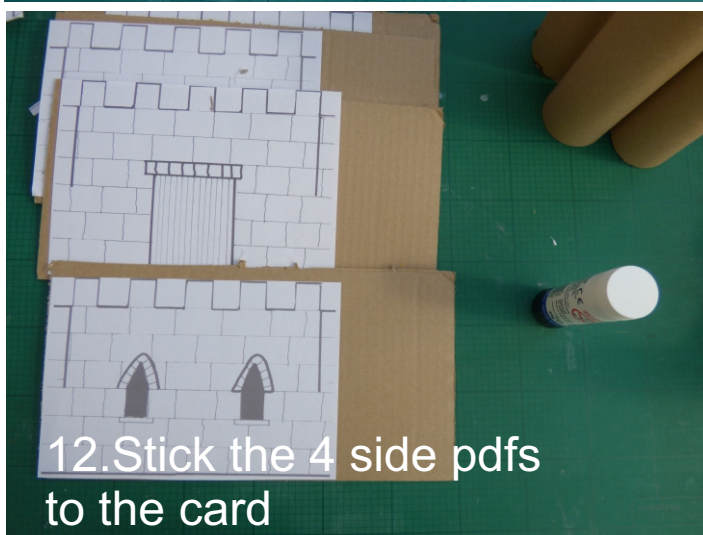

13 Cut out and trim to size including the door

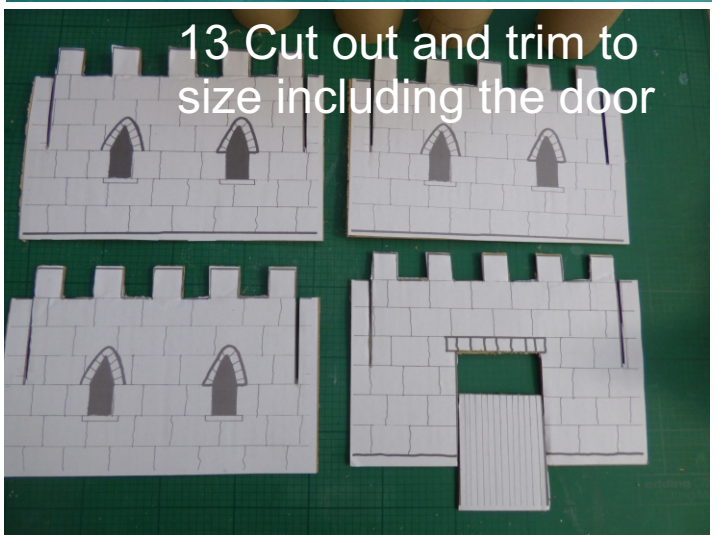

14. Slot the front and back to the turrets

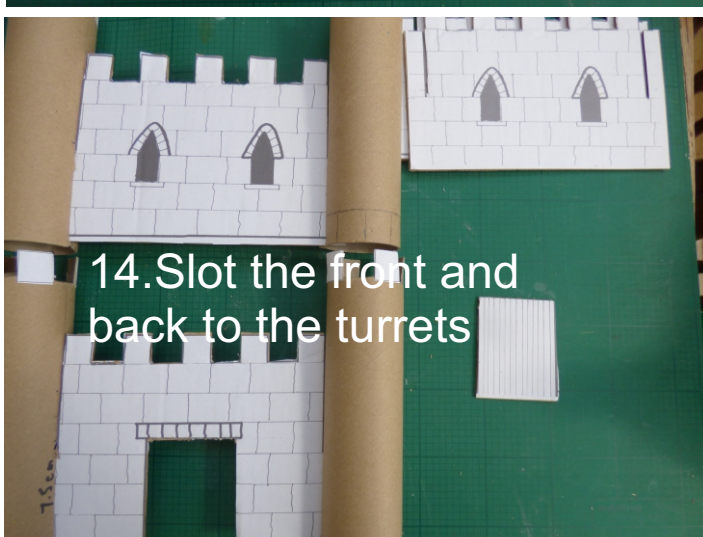

15. Turn over and mark other slots



# Instructions for Cardboard Castle

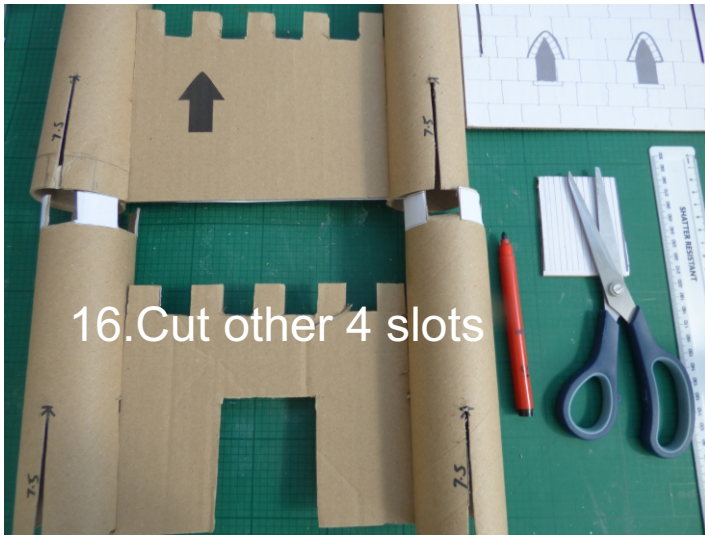

16. Cut other 4 slots



17. Get string, wooden skewer and straw and sellotape



18. Cut skewer to 10cm and straw 5 x 2cm. Stick skewer to door with tape



19. Make holes indoor and front wall.



20 Fix door to straws with sellotape

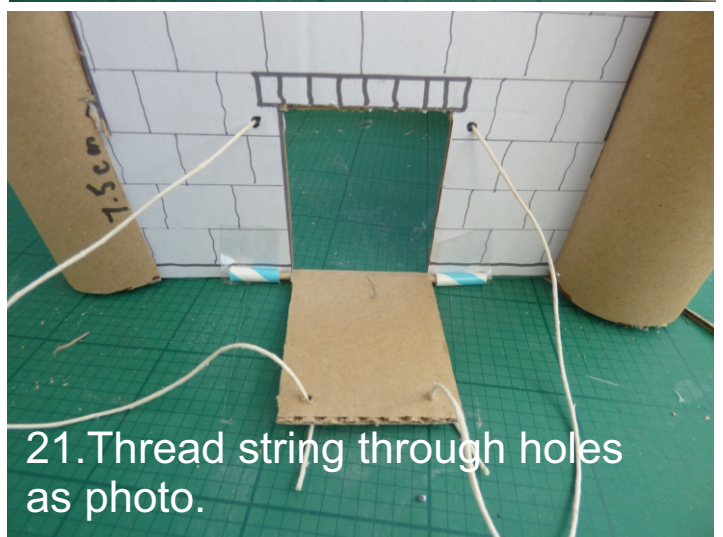

21. Thread string through holes as photo.



22. Cut out figures from PDF



23. Stick them to card

# Instructions for Cardboard Castle

